

## RF Coaxial Rotary Joint

RF rotary joints are used in cables, antennas and other passive components. When rotating or twisting is required, they are used to protect the passive components of the DUT from damage, and also to keep the influence on measurement caused by rotations to a minimum.



### Technical Specifications

	PC-C62	PC-C64	PC-C65
<b>Material</b>			
Inner Conductor	Beryllium Copper	Beryllium Copper	Beryllium Copper
Dielectric	PTFE	PTFE	PTFE
Outer Conductor	Beryllium Copper	Beryllium Copper	Beryllium Copper
Housing	Stainless Steel	Stainless Steel	Stainless Steel
<b>Mechanical</b>			
Rotation Torque (In-Oz)	6	5	5
Rotation Rate (RPM)	100	100	100
<b>Electrical</b>			
Frequency Range (GHz)	DC-20	DC-40	DC-50
Impedance (ohM)	50	50	50
VSWR	1.25	1.65	1.7
Insertion Loss (dB)	0.5	0.7	0.9
VSWR Tolerance	0.05	0.05	0.2
Insertion Loss Tolerance (dB)	0.1	0.1	0.15
Average Power Capacity at 1GHz (Watt)	100	50	15
Peak Power Capacity at 1GHz (Watt)	500	500	500



### Atenlab Corporation

6F., No.8, Aly.15, Ln.120, Sec.1, Neihu Rd., Neihu Dist., Taipei City 114, Taiwan  
 T : +886 2 2799 8715 F : +886 2 2799 8915 E : [atenlab@atenlab.com.tw](mailto:atenlab@atenlab.com.tw)

PC-C62

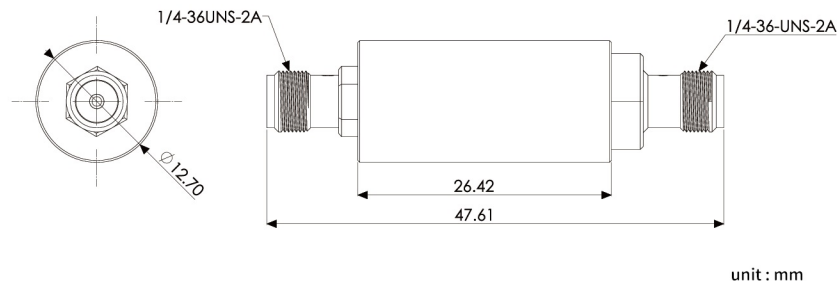

PC-C64

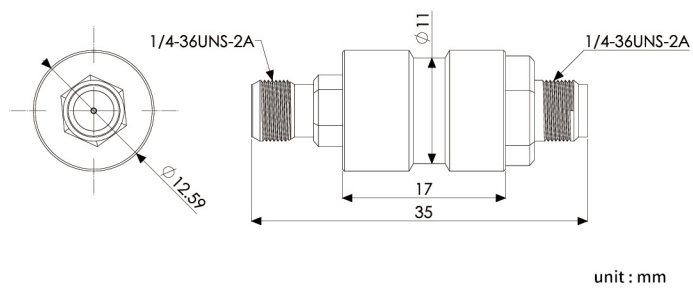

PC-C65

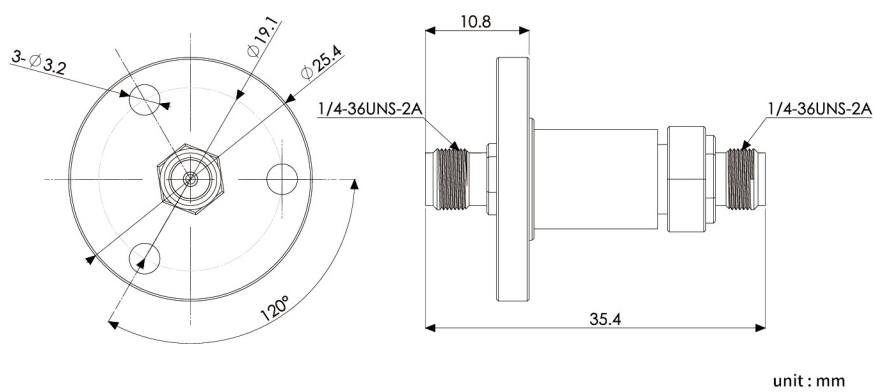

PC-C62

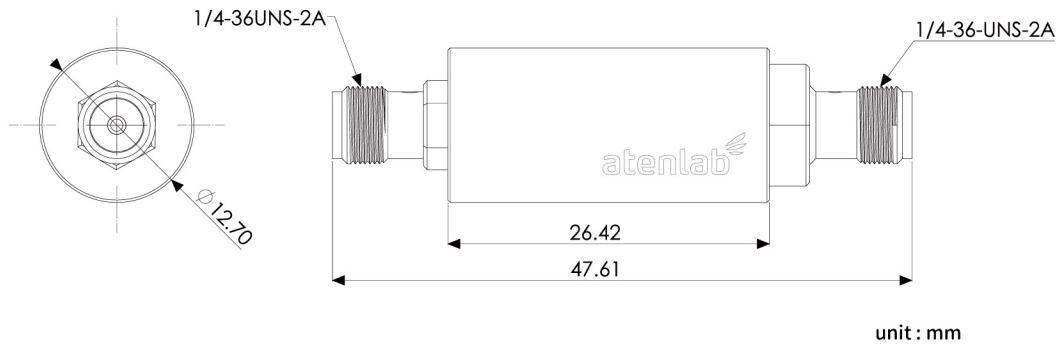

PC-C62 — PC-C64 — PC-C65 —

